



## Centre Highlights

Located at the intersection of Broadway Ave & Bayview Ave in the City of Toronto, this grocery anchored centre offers a total of 70,318 sq. ft of prime retail space, featuring retailers such as Whole Foods, Shoppers Drug Mart, TD, and Cyclebar.

### FEATURES

- Ample parking
- Located by a prime residential area
- Easily accessible by vehicle and public transit
- Excellent tenant mix
- Serves a desirable demographic

Note: All demographic information is Copyright 2020 by Environics Analytics (EA).  
Source: DemoStats 2019, DemoStats 2020.

**Centre Address:** 1860 Bayview Avenue

**City/Province:** Toronto, ON

**Property Size:** 70,318 sq. ft.

**Latitude/Longitude:** 43.71434 N, -79.37816 W

## Demographics : 3 Km Radius



**Population:**

**142,281**



**Number of Households:**

**63,793**



**Average Household Income:**

**\$213,169**

## Contact Us

**Ryan Ramlal**

Leasing Contact

Phone: 647-253-4960

Email: rramlal@riocan.com

2300 Yonge Street Suite 500 P.O. Box  
2386

**Retail Leasing**

Leasing Agent

**RioCan**

2300 Yonge Street, Suite 500 • Toronto, ON Canada M4P1E4 • 1.800.465.2733

**Ground Floor**

1860 BAYVIEW – GROUND FLOOR

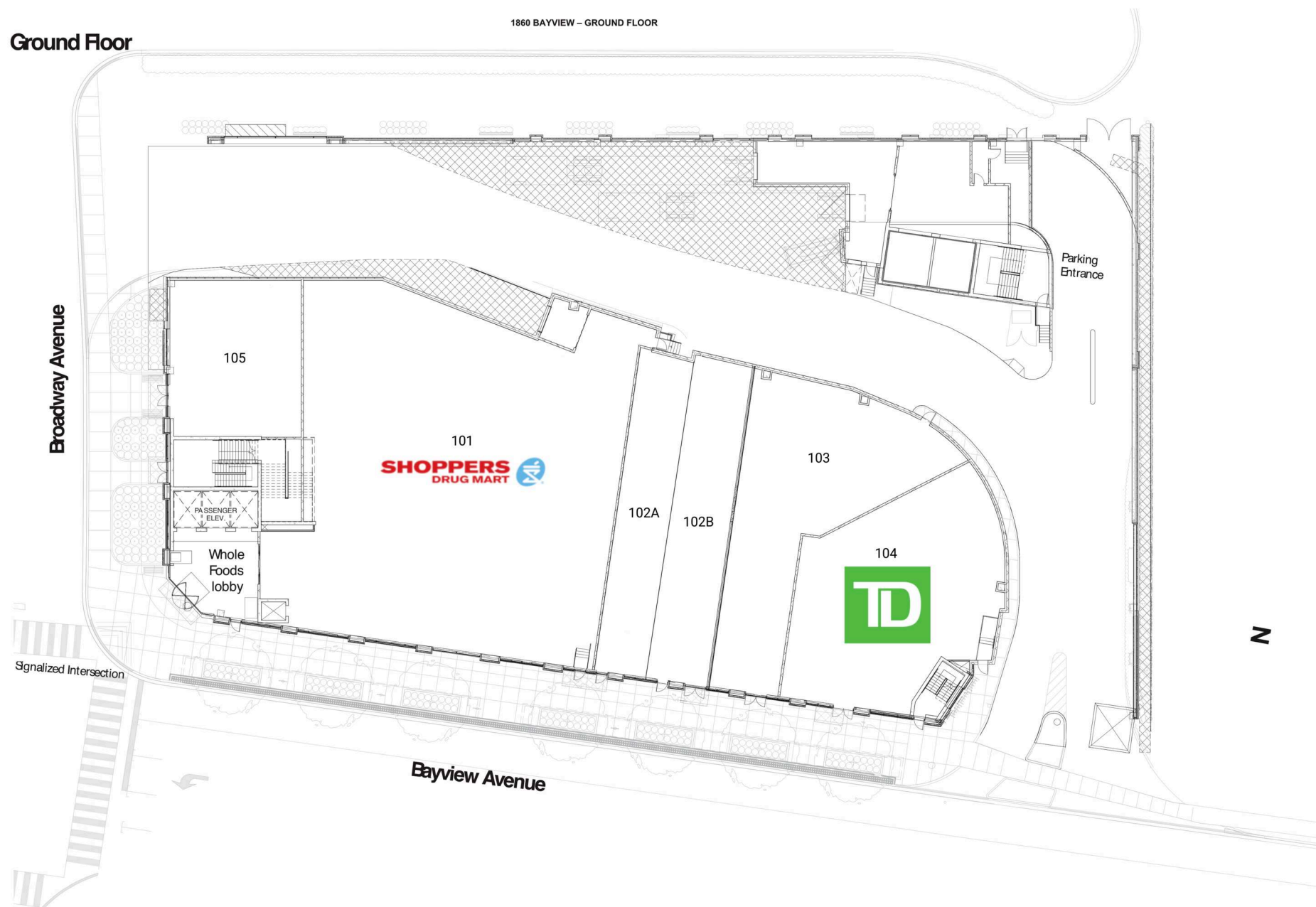

**Second Floor**

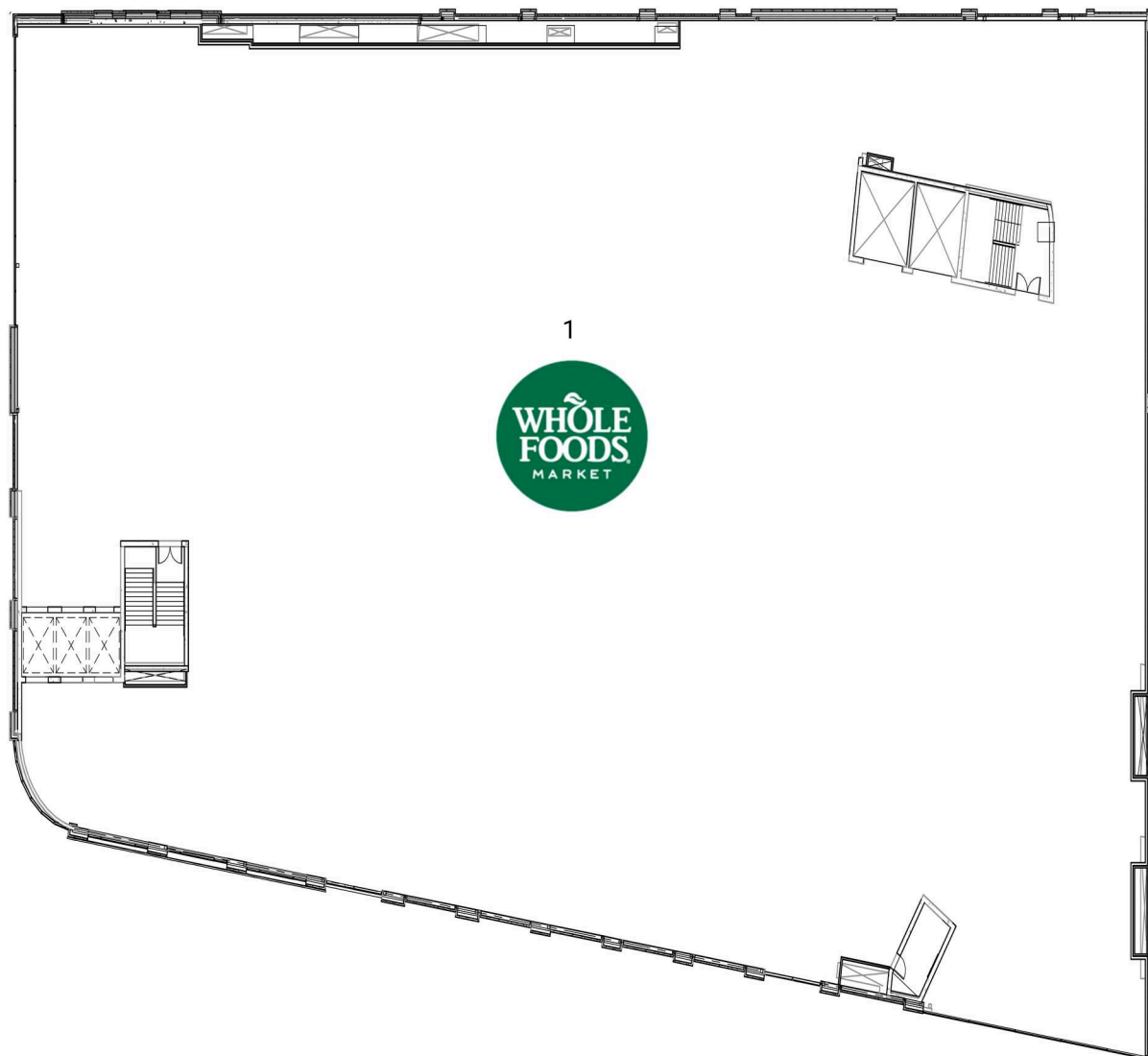



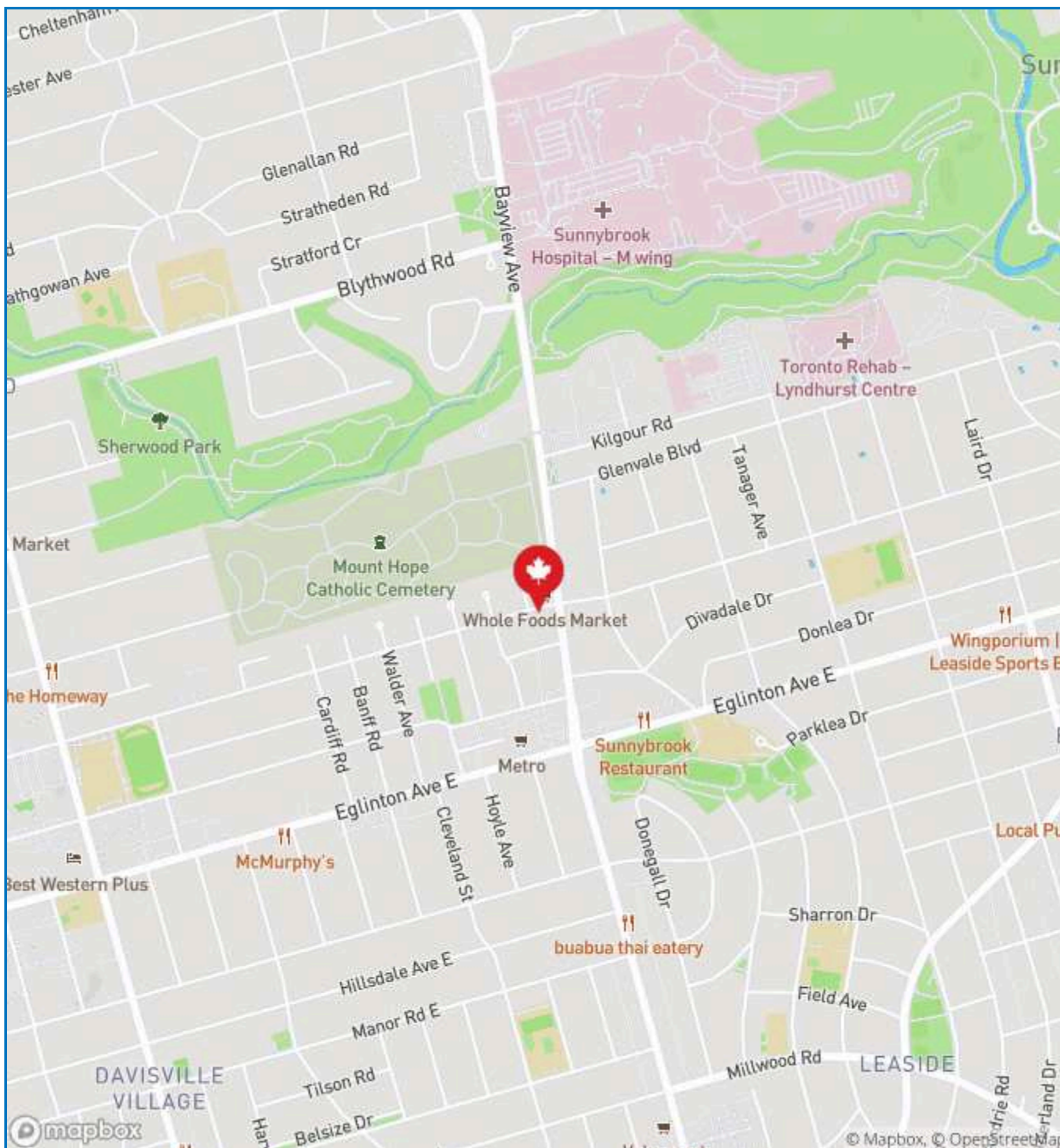

## Demographics



### Population:

3 Km **142,281**

5 Km **436,005**



### Number of Households:

3 Km **63,793**

5 Km **188,221**



### Average Household Income:

3 Km **\$213,169**

5 Km **\$205,814**



### Median Age:

3 Km **40**

5 Km **41**