

Stock Yards Village

1980 St Clair Avenue West, Toronto, ON

- A120 - La Vie En Rose - 3,006 sqft
- A121 - The Children's Place - 4,002 sqft
- A122 - The Shoe Company - 6,003 sqft
- A133 - Walking On A Cloud - 2936 sqft
- G101 - Sunset Grill - 2,021 sqft
- G103 - Bell - 1,211 sqft
- G102 - Available - 1,238 sqft
- G104 - Second Cup - 1,539 sqft

- H101 - Philthy Philly's - 1,522 sqft
- H105 - Chatime - 1,387 sqft
- H103 - Nails For You - 964 sqft
- H104 - Panda Express - 2,337 sqft
- J103 - Booster Juice - 854 sqft
- J104 - Hero Pizza - 918 sqft
- J101 - Rogers/Fido - 1,984 sqft
- J107 - Sweet A La Mode - 2,414 sqft

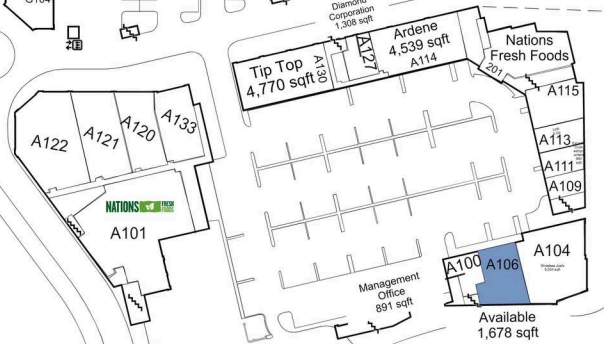
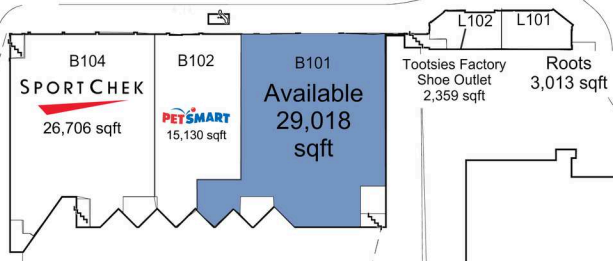
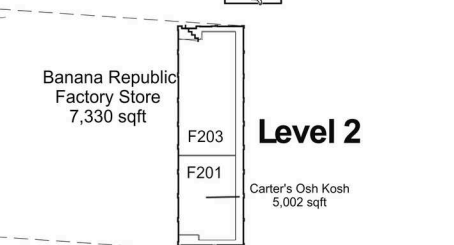
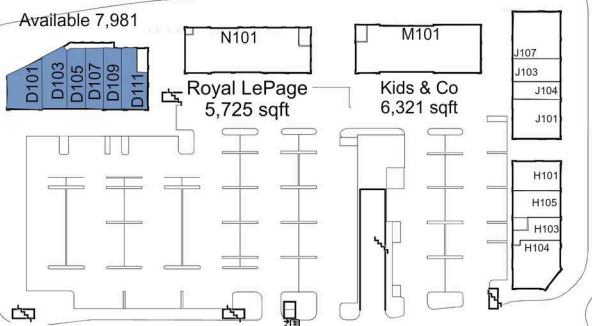
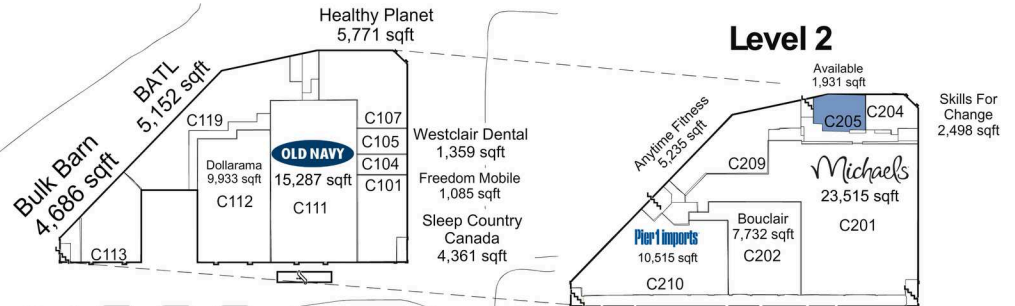

- A115 - Snuggle Bugz - 2,708 sqft
- A113 - Link It Up - 1,060 sqft
- A111 - Expedia Cruiseshipcenters - 960 sqft
- A109 - The Stockyards Eye Care Centre & C Wave Optical - 936 sqft
- A104 - Shoeless Joe's - 6,004 sqft
- A130 - Addition Elle - 4,770 sqft

- I101 - Five Guys - 2,280 sqft
- I102 - Pita Pit - 867 sqft
- I103 - Thai Express - 1,210 sqft
- I104 - Made in Japan Teriyaki Experience 976 sqft
- I105 - Marble Slab Creamery 979 sqft

Available Shadow Anchor

This site plan is presented solely for the purpose of identifying the approximate location and size of the building, and intended for use as a reference only.
Ce plan de site est présenté uniquement dans le but d'identifier l'emplacement approximatif et la taille du bâtiment, et destiné à être utilisé comme référence seulement.