

Stock Yards Village

1980 St Clair Avenue West, Toronto, ON

- A120 - La Vie En Rose - 3,006 sqft
- A121 - The Children's Place - 4,002 sqft
- A122 - The Shoe Company - 6,003 sqft
- A133 - Walking On A Cloud - 2936 sqft
- G101 - Sunset Grill - 2,021 sqft
- G102 - Available - 1,238 sqft
- G103 - Bell - 1,211 sqft
- G104 - Second Cup - 1,539 sqft

- H101 - Philthy Philly's - 1,522 sqft
- H105 - Chatime - 1,387 sqft
- H103 - Nails For You - 964 sqft
- H104 - Panda Express - 2,337 sqft
- J103 - Booster Juice - 854 sqft
- J104 - Hero Pizza - 918 sqft
- J101 - Rogers/Fido - 1,984 sqft
- J107 - Sweet A La Mode - 2,414 sqft

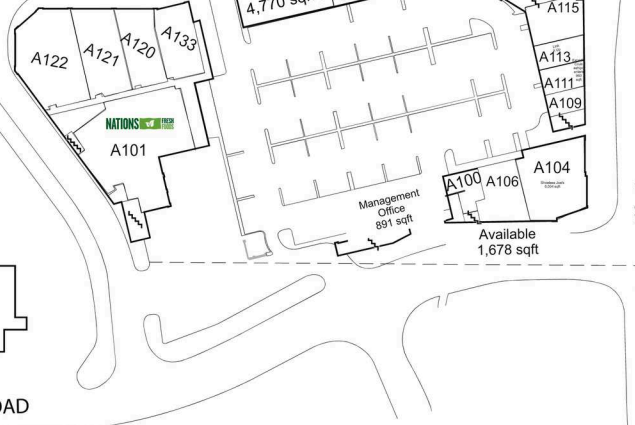
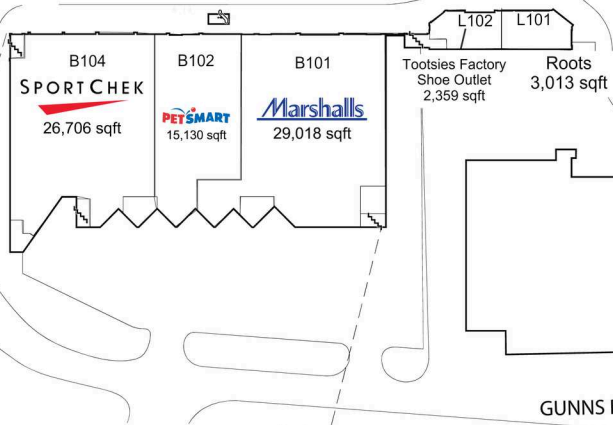
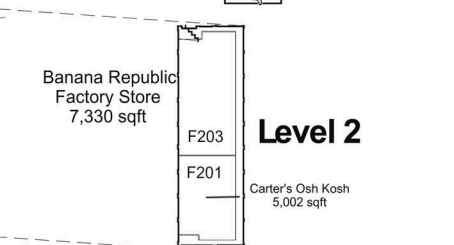
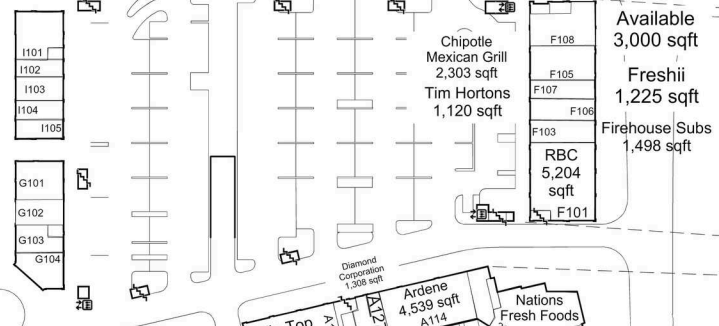
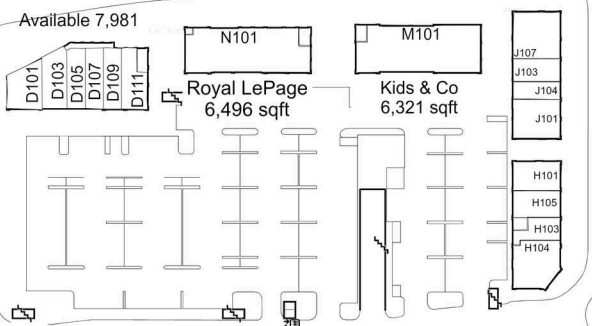
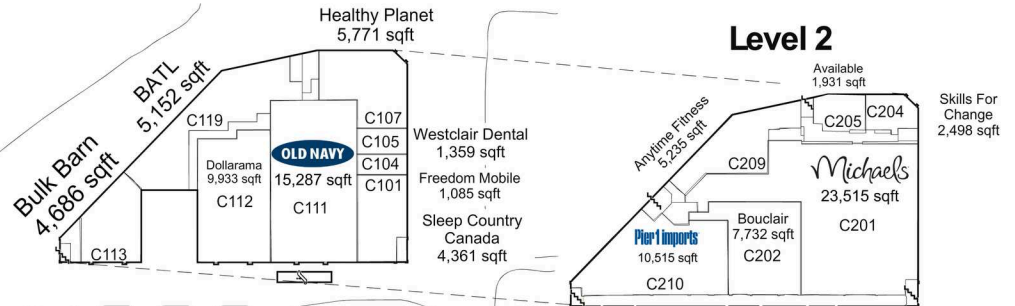

Level 2

- A115 - Snuggle Bugz - 2,708 sqft
- A113 - Link It Up - 1,060 sqft
- A111 - Expedia Cruiseshipcenters - 960 sqft
- A109 - The Stockyards Eye Care Centre & C Wave Optical - 936 sqft
- A104 - Shoeless Joe's - 6,004 sqft
- A130 - Addition Elle - 4,770 sqft

- I101 - Five Guys - 2,280 sqft
- I102 - Pita Pit - 867 sqft
- I103 - Thai Express - 1,210 sqft
- I104 - Made in Japan Teriyaki Experience 976 sqft
- I105 - Marble Slab Creamery 979 sqft

Shadow Anchor