



Lawrence Allen Centre, Toronto, Ontario



Situé à l'intersection de l'avenue Lawrence ouest et du chemin Allen à Toronto, ce centre commercial à construction fermée comprend 120 unités totalisant 657 821 pi2 et inclut des détaillants tels que Canadian Tire, Fortino's, Marshalls, HomeSense, Structube et PetSmart.

Population 

466,243

Revenu moyen des ménages 

\$0

Ménages avec des enfants 

40%

Âge médian 

51 years

Toutes les données représentent l'information dans un rayon de 5 Km du centre.

Source: Toute l'information démographique est protégée par les droits d'auteur 2024 de Environics Analytics (EA)



FORTINOS
Your neighbourhood store

HOMESENSE

Fit 4 Less
by Goodie

PETSMART

DOLLARAMA

Rexall

Lawrence Allen Centre

Toronto, Ontario
700 Lawrence Avenue West
Lawrence Ave & Allen Express Way

Ryan Ramlal
rramlal@riocan.com
647-253-4960

Cody Perza
cperza@riocan.com
647-388-9036



Locataire pilier fantôme

K013	The Ticket Shop	200 PI2	120	The Source	1,639 PI2	243	New Time Square	232 PI2	430	Available	2,425 PI2
K014	Value Mobile	150 PI2	122	Toys R Us (Temp)	3,400 PI2	244	Omni Jewelcrafters	1,152 PI2	433	Traditional Chinese Med	3,724 PI2
M002	Canadian Tire	86,761 PI2	124	The Foot Institute	2,303 PI2	245	Omni Jewelcrafters	1,198 PI2	435	Career Foundation	3,924 PI2
M002-2	Canadian Tire	86,761 PI2	128	Easyfinancial	1,385 PI2	246	Inch By Inch Children's Wear	792 PI2	440	Unison Health and Community Services	2,198 PI2
M03C	Marshalls	26,851 PI2	129	Giannini Shoes	1,565 PI2	247A	Wikki Hut	452 PI2	440A	Career Foundation	1,374 PI2
M03D	Structube	14,500 PI2	135	Value Mobile	835 PI2	247B	Hello Pho	370 PI2	445	RioCan Management Office	2,575 PI2
PAD1	Available	103,725 PI2	140	Phone Cards Plus	296 PI2	248	Real Fruit Bubble Tea	992 PI2	476A	Distress Centres of Toronto	1,127 PI2
3	Available	6,532 PI2	201	Dollarama	9,612 PI2	315	RioCan Management Office	16,180 PI2			
9	Bell	1,306 PI2	206	Dentistry in Motion	2,891 PI2	325	COTA Health	2,413 PI2			
112	Ardene	2,552 PI2	207	Budget Shoes	1,408 PI2	350	North York Community House	2,608 PI2			
114	Wear 2000	316 PI2	209	Ardene	9,848 PI2	365A	LLA Architecture +	2,503 PI2			
115A	Scotiabank	16 PI2	212	On Top Nail Art	959 PI2						
117A	Tim Hortons	1,804 PI2	213A	Marvels Children's	1,320 PI2						
						215	Premier Hair Centre	1,083 PI2			
						217	Value Village	10,333 PI2			
						223	Toys R Us	15,641 PI2			
						227	Omni Java Cafe	485 PI2			
						229A	McDonald's	563 PI2			
						229B	Pita Land	408 PI2			
						230	Bar Burrito	511 PI2			
						231	Asian Gourmet	504 PI2			
						232	KFC	509 PI2			
						234	Mango Thai Kitchen	1,363 PI2			
						235	Fit 4 Less	13,386 PI2			
						238A	Medix	419 PI2			

Lawrence Allen Centre

Toronto, Ontario
700 Lawrence Avenue West
Lawrence Ave & Allen Express Way

Ryan Ramlal
rramlal@riocan.com
647-253-4960

Cody Perza
cperza@riocan.com
647-388-9036

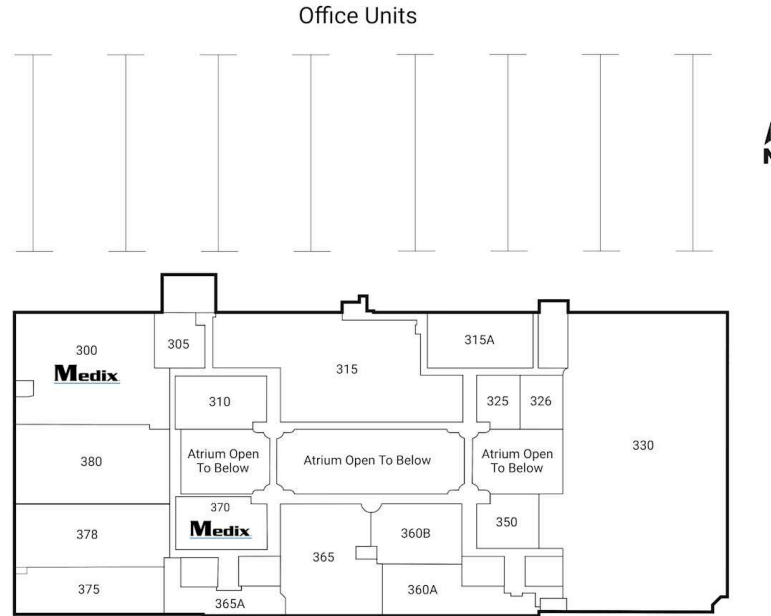

Locataire pilier fantôme

K013	The Ticket Shop	200 PI2	201	Dollarama	9,612 PI2	315	RioCan Management Office	16,180 PI2	378	Available	8,325 PI2
M002	Canadian Tire	86,761 PI2	207	Budget Shoes	1,408 PI2	315A	Available	5,357 PI2	380	NPower Canada	11,006 PI2
PAD1	Available	103,725 PI2	209	Bluenotes	9,848 PI2	325	Available	2,413 PI2	430	Available	2,425 PI2
3	Bzz-E-Kids	6,532 PI2	213A	Marvels Children's Wear	1,320 PI2	326	Available	2,059 PI2	433	Toronto School Traditional Chinese Med	3,724 PI2
9	Bell	1,306 PI2	217	Suzy Shier	4,711 PI2	330	City of Toronto	43,681 PI2	435	Career Foundation	3,924 PI2
112	Ardene	2,552 PI2	218	Mayar Lingerie	825 PI2	350	The Oaks Revitalization Association	2,608 PI2	440	Unison Health and Community Services	2,198 PI2
114	Wear 2000	316 PI2	219	Pacific Florist	1,027 PI2	360A	Toronto School Traditional Chinese Med	6,339 PI2	440A	Career Foundation	1,374 PI2
115A	Scotiabank	16 PI2	223	Bulk Villa	2,394 PI2	360B	RioCan Management Office	4,200 PI2	445	RioCan Management Office	2,575 PI2
117A	Tim Hortons	1,804 PI2	229A	McDonald's	563 PI2	365	RioCan Management Office	8,659 PI2	476A	Available	1,127 PI2
120	The Source	1,639 PI2	235	Fit 4 Less	13,386 PI2	365A	LLA Architecture + Medix	2,503 PI2			
122	Fairweather	3,400 PI2	243	New Time Square	232 PI2	370	Medix	4,331 PI2			
124	The Foot Institute	2,303 PI2	246	Inch By Inch Children's Wear	792 PI2	375	Byron Equities	8,175 PI2			
128	Easyfinancial	1,385 PI2	300	Medix	14,538 PI2						
129	Giannini Shoes	1,565 PI2	305	Medix	1,443 PI2						
135	Value Mobile	835 PI2	310	VHA Home Healthcare	4,424 PI2						
140	Phone Cards Plus	296 PI2									

Ce plan de site est présenté uniquement dans le but d'identifier l'emplacement approximatif et la taille du bâtiment, et destiné à être utilisé comme référence seulement.

riocan.com | 1-800-465-2733

Lawrence Allen Centre

Toronto, Ontario
700 Lawrence
Avenue West
Lawrence Ave &
Allen Express Way

Ryan Ramlal
rramlal@riocan.com
647-253-4960

Cody Perza
cperza@riocan.com
647-388-9036

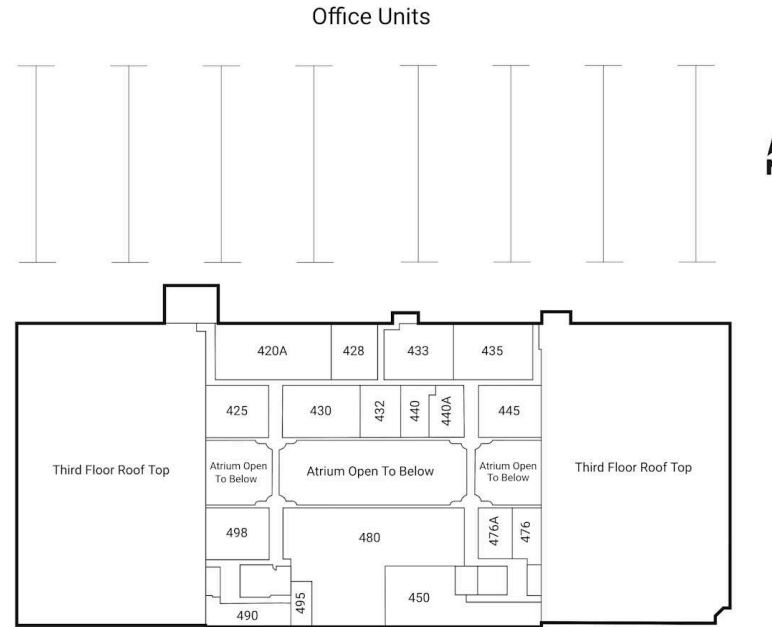

Locataire pilier fantôme

K013	The Ticket Shop	200 PI2	135	Value Mobile	835 PI2	315	RioCan Management Office	16,180 PI2	435	Career Foundation	3,924 PI2
M002	Canadian Tire	86,761 PI2	140	Phone Cards Plus	296 PI2	325	COTA Health	2,413 PI2	440	Unison Health and Community Services	2,198 PI2
PAD1	Available	103,725 PI2	201	Dollarama	9,612 PI2	350	North York Community House	2,608 PI2	440A	Career Foundation	1,374 PI2
3	Bzz-E-Kids	6,532 PI2	207	Budget Shoes	1,408 PI2	365A	LLA Architecture + Available	2,503 PI2	445	RioCan Management Office	2,575 PI2
9	Bell	1,306 PI2	209	Bluenotes	9,848 PI2	420A	Reconnect Community Health Services	3,145 PI2	450	Canadian Beauty College	6,615 PI2
112	Ardene	2,552 PI2	213A	Marvels Children's Wear	1,320 PI2	425	Ontario Conservatory of Music	1,740 PI2	476	Lawyers	1,882 PI2
114	Wear 2000	316 PI2	217	Suzy Shier	4,711 PI2	428	Available	2,899 PI2	476A	Behaviour Matters	1,319 PI2
115A	Scotiabank	16 PI2	218	Mayar Lingerie	825 PI2	430	LA Clinik & Wellness Corporation	2,020 PI2	480	CMHA	13,044 PI2
117A	Tim Hortons	1,804 PI2	219	Pacific Florist	1,027 PI2	432	Toronto School Traditional Chinese Med	2,724 PI2	490	Tax to Go	1,890 PI2
120	The Source	1,639 PI2	223	Bulk Villa	2,394 PI2				495	Available	950 PI2
122	Fairweather	3,400 PI2	229A	McDonald's	563 PI2				498	Stu View Overseas	3,127 PI2
124	The Foot Institute	2,303 PI2	235	Fit 4 Less	13,386 PI2						
128	Easyfinancial	1,385 PI2	243	New Time Square	232 PI2						
129	Giannini Shoes	1,565 PI2	245	Inch By Inch Children's Wear	732 PI2						

Ce plan de site est présenté uniquement dans le but d'identifier l'emplacement approximatif et la taille du bâtiment, et destiné à être utilisé comme référence seulement.