



602-606 King Street West, Toronto, Ontario



602-606 King Street West is a mixed-use development located in Toronto’s King West neighbourhood, including platinum LEED targeted office and ground level retail, in a newly built 14-storey tower, and a 132 unit residential condominium named Kingly. The site also includes an existing 3-storey commercial building with

Population 

1,332,101

Average Household Income 

\$136,540

Households with Children 

30%

Median Age 

38 years

All figures are within a 10 Km radius.

Source: All demographic information is Copyright 2024 by Environics Analytics (EA).

Site Plan

602-606 King Street West

Toronto, Ontario
602-606 King Street
West

■ **Shadow Anchor**

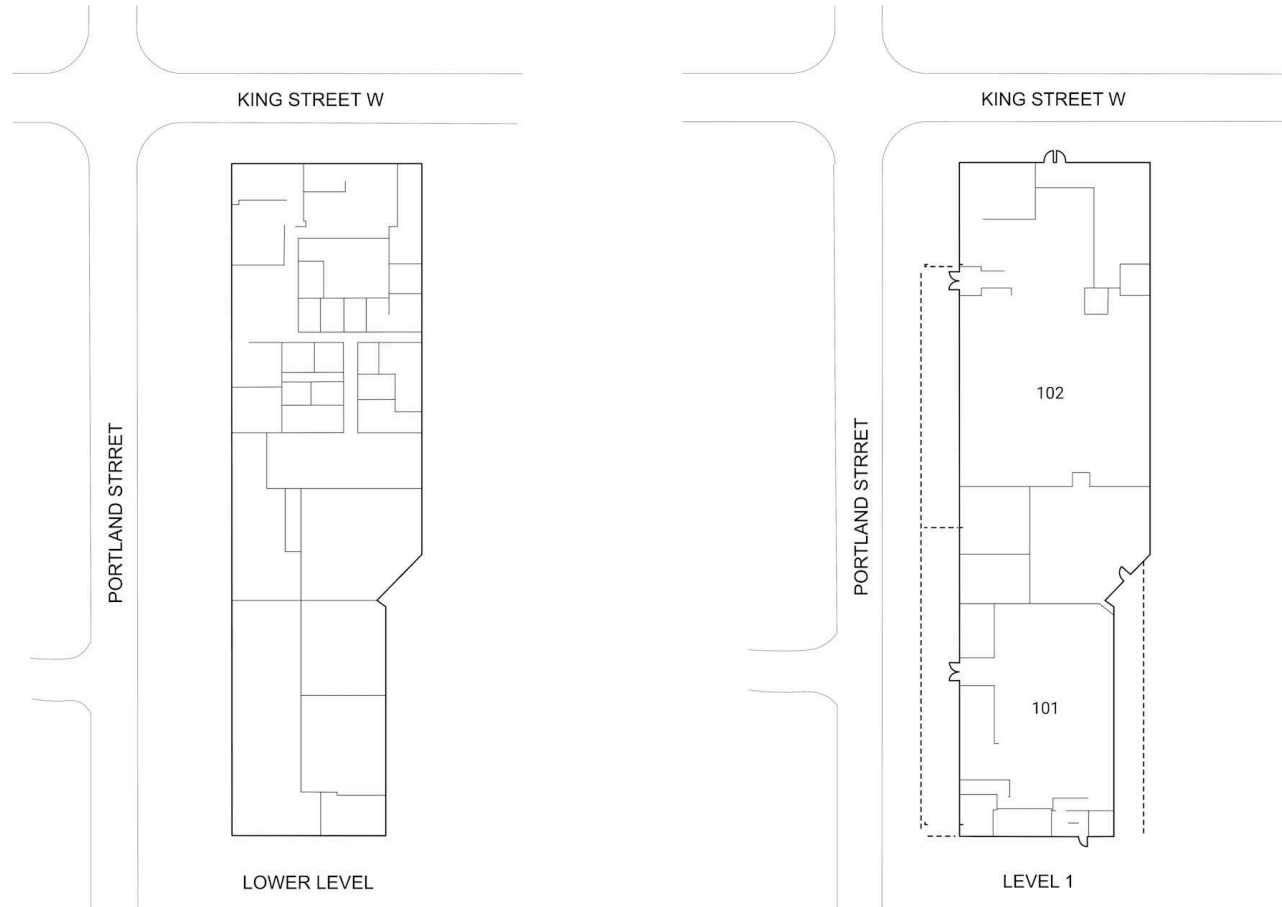

101 Bruno

4,350 SF

102 Upchain

6,700 SF